

Aussie[®] by Meco[®]



Gas Grill



LP cylinder not included

MODEL 4280 WALK-A-BOUT[®]

OWNER'S MANUAL

FOR OUTDOOR HOUSEHOLD USE ONLY. NOT FOR COMMERCIAL USE.

For Customer Service, call 1-800-251-7558 or visit our web site at www.meco.net

⚠ WARNING

- Failure to follow these instructions could result in fire or explosion which could cause death, serious personal injury, or property damage.
- Read and follow instructions carefully before assembly or use.
- **Do not** use this product for any other purpose than which it is intended.
- These instructions must be kept with the user. **SAVE THESE INSTRUCTIONS.**

FOR YOUR SAFETY

If you smell gas:

1. Do not attempt to light appliance.
2. Extinguish any open flame.
3. Disconnect from fuel supply.

FOR YOUR SAFETY

1. Do not store or use gasoline or other flammable vapors and liquids within 25 feet (7.62m) of this or any other appliance.
2. An LP cylinder not connected for use shall not be stored within 10 feet (3.05m) in the vicinity of this or any other appliance.
3. Do not store any LP gas cylinder indoors.

CONTENTS

<p>I. Features That Make Your Grill Outstanding.....2</p> <p>II. Assembly Instructions.....3</p> <p style="padding-left: 20px;">A) Parts List and Illustrations.....3</p> <p style="padding-left: 20px;">B) Setting up Your Grill.....4</p> <p style="padding-left: 20px;">C) Install Grease Cup.....5</p> <p style="padding-left: 20px;">D) Connecting/Disconnecting LP Cylinder.....5</p> <p style="padding-left: 40px;">1) Installation Codes.....5</p> <p style="padding-left: 40px;">2) LP Cylinder.....5</p> <p style="padding-left: 40px;">3) Regulator/Manifold Assembly.....5</p> <p>III. Attach LP Cylinder to Gas Grill.....6</p> <p style="padding-left: 20px;">A) 1 lb. LP Cylinder.....6</p> <p style="padding-left: 20px;">B) 20 lb. LP Cylinder.....6</p> <p>IV. Operating and Maintaining Your LP Gas Grill.....7</p> <p style="padding-left: 20px;">A) Before Using Your Grill.....7</p> <p style="padding-left: 40px;">1) Using Gas.....7</p> <p style="padding-left: 40px;">2) Selecting a Location.....7</p> <p style="padding-left: 40px;">3) Performing a Leak Test.....7</p> <p style="padding-left: 20px;">B) Lighting the Gas Grill.....8</p>	<p style="padding-left: 20px;">1) Ignition Lighting the Grill.....8</p> <p style="padding-left: 20px;">2) Manual Lighting the Grill.....9</p> <p style="padding-left: 20px;">3) Check Your Flame.....9</p> <p>C) Operating the LP Gas Grill.....9</p> <p style="padding-left: 20px;">1) Grill Cooking.....10</p> <p style="padding-left: 20px;">2) End of Cooking Session.....10</p> <p>D) Care and Maintenance.....10</p> <p style="padding-left: 20px;">1) Cleaning the Grill.....10</p> <p style="padding-left: 40px;">a) Grease Cup.....10</p> <p style="padding-left: 40px;">b) Cooking Grid.....10</p> <p style="padding-left: 40px;">c) Hood10</p> <p style="padding-left: 40px;">d) Bowl.....10</p> <p style="padding-left: 40px;">e) Burners.....10</p> <p style="padding-left: 20px;">2) Cleaning the Burners.....11</p> <p style="padding-left: 20px;">3) Storage and Transport.....11</p> <p>V. Important Notice-LP Cylinder with OPD.....13</p> <p>VI. Troubleshooting.....14</p> <p>VII. Limited Warranty.....15</p>
---	--

— NOTICE —

MECO CORPORATION STRIVES TO BE A QUALITY SUPPLIER OF CONSUMER PRODUCTS. IF WE OMITTED ANY PARTS NEEDED FOR ASSEMBLY, OR YOU NEED TROUBLESHOOTING INFORMATION, PLEASE CONTACT US USING OUR TOLL FREE NUMBER. THANK YOU FOR PURCHASING A MECO CORPORATION PRODUCT.

1-(800)-251-7558
 8 am - 6 pm E.S.T Mon. - Fri.
1-(423)-639-1171 (TELEPHONE)
1-(423)-639-2570 (FAX)

www.meco.net

CONSUMER SERVICE DEPARTMENT
MECO CORPORATION
1500 INDUSTRIAL ROAD
GREENEVILLE, TN. 37745 USA

FEATURES THAT MAKE YOUR AUSSIE® GRILL OUTSTANDING

Exclusive Easy Folding & Locking Legs For Easy Transport...

Aussie® locking legs fold-up and lock to make your grill easily portable and compact for easy storage. You may lean your grill against a wall or hang on the side of a wall.



Convenient Hood/Bowl Latch...

The Aussie® Gas Grill has a latch to lock Hood and Bowl together when Grill legs are folded and Grill is stored.

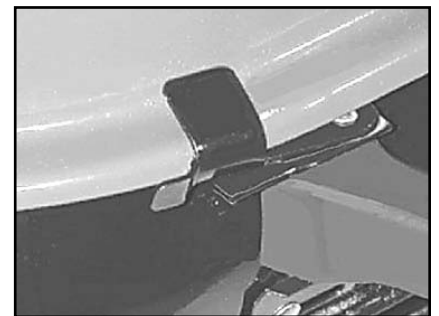

Efficient Draft System For Complete Control...

The Aussie® Gas Grill Hood has an adjustable vent. You can adjust this vent to control smoke and flare-ups.

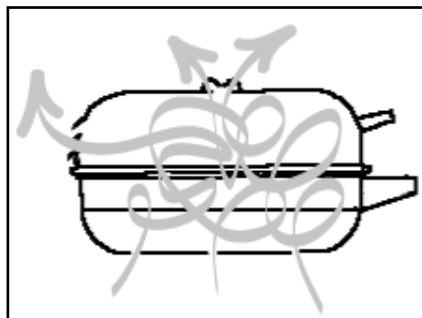

Convenient Raised Cooking Grid...

The Aussie® Cooking Grid is designed with raised feet so food can be removed from grill all at once and placed on a table or counter top without touching the surface.

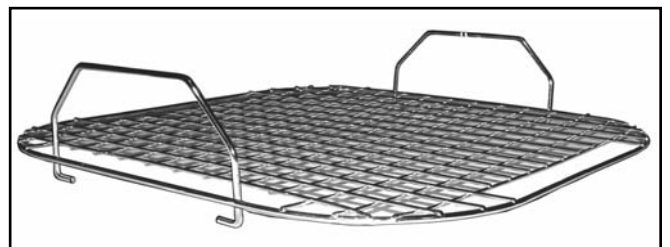

⚠ DANGER



CARBON MONOXIDE HAZARD

This appliance can produce carbon monoxide which has no odor.

Using it in an enclosed space can kill you.

Never use this appliance in an enclosed space, such as a camper, tent, car or home.

ASSEMBLY INSTRUCTIONS

⚠ WARNING

To reduce the risk of serious bodily injury or death:

- The use of alcohol, prescription or non-prescription drugs could impair the consumer's ability to properly assemble or safely operate this appliance.
- Do not connect LP cylinder until assembly is complete.

PREPARATION FOR ASSEMBLY: Note: This Grill is pre-assembled. Only the Propane cylinder needs to be attached. Unlock Hood Latch. (See Fig. 4, page 4) Remove Cooking Grid, Grease Cup and Owner's Manual from grill. Make sure there are no loose parts before discarding any packing materials. **Note: Before using your grill, read the instructions and this Owner's Manual.** For easier set-up and assembly, follow instructions of each step in the order they are written as you look at the illustrations.

If you need replacement parts, look in the Parts List Section to find the exact parts you need. If you have any questions or need help, contact our Consumer Service Department. Be sure to mention the grill model number.

PARTS LIST AND ILLUSTRATIONS

PARTS LIST			
ITEM	DESCRIPTION	PART #	QTY.
1	Owners Manual	03.6097.00	1
2	Cooking Grid	03.7000.00	1
3	Grid Bracket	03.6103.00	4
4	Hood Handle	03.6102.00	1
5	Leg Insert	03.6114.00	2
6	Screw, Tap 6-20 x 3/8" Type AB	03.0303.00	3
7	Screw, Tap 8-18 x 3/8" Type B	03.1827.00	2
8	Lockwasher, #10	03.XXXX.00	2
9	Screw, Tap #12-14 x 3/8" Type BT	03.0312.00	2
10	Screw, Tap 10-16 x 5/8" Type AB	03.0301.01	8
11	Screw, Tap #12-14 x 1" Type AB	03.XXXX.00	1
12	Piezo	03.6320.00	1
13	Locknut (Piezo)	03.6383.00	1
14	Burner Tent	03.6323.00	2
15	Grease Cup/Wire Hook	03.6324.00	1
16	Burner	03.6325.00	2
17	Control Panel	03.6327.00	1
18	Electrode	03.6328.00	2
19	Regulator/Manifold Assembly	03.6384.00	1
20	Regulator Clip	03.6475.00	2
21	Regulator Spacer	03.6479.00	1

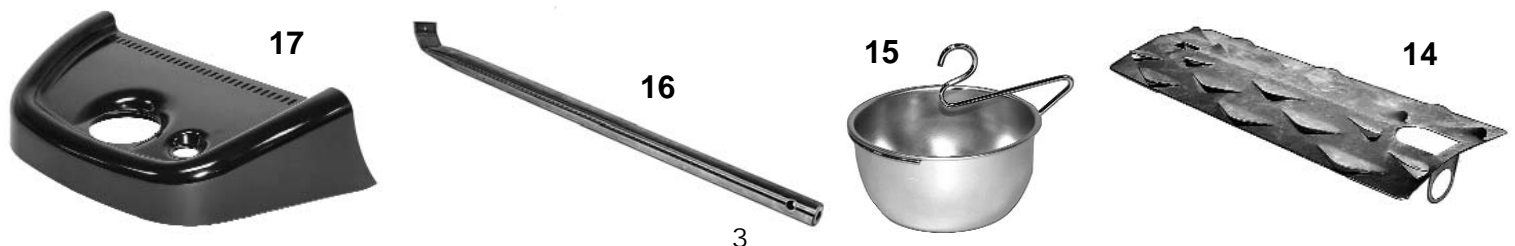
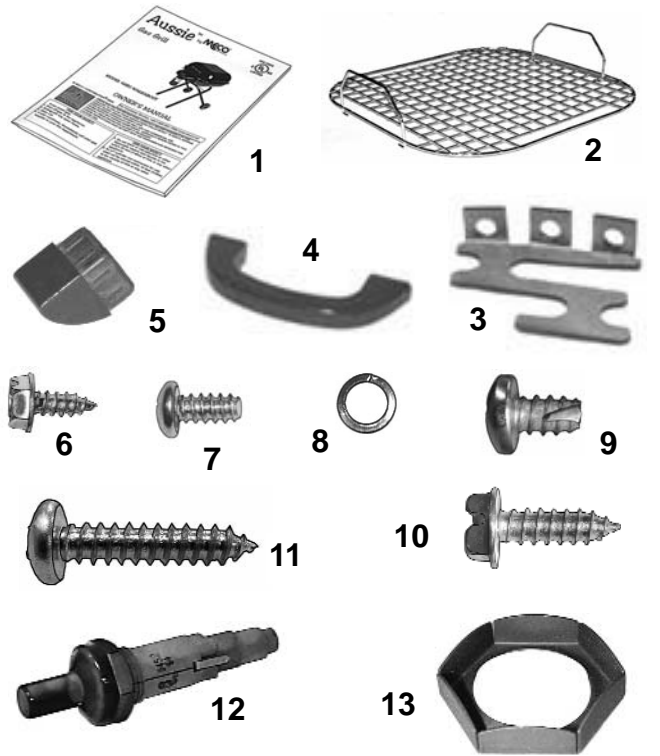

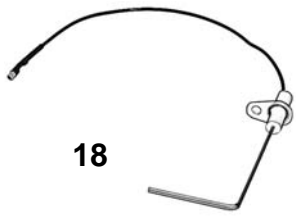

18



19



20



21

SETTING UP YOUR GAS GRILL

⚠ CAUTION

To reduce the risk of a cut, pinching or other bodily injury:

- Wear protective gloves when handling parts that could have sharp edges.
- Be careful while folding and unfolding the Grill legs.

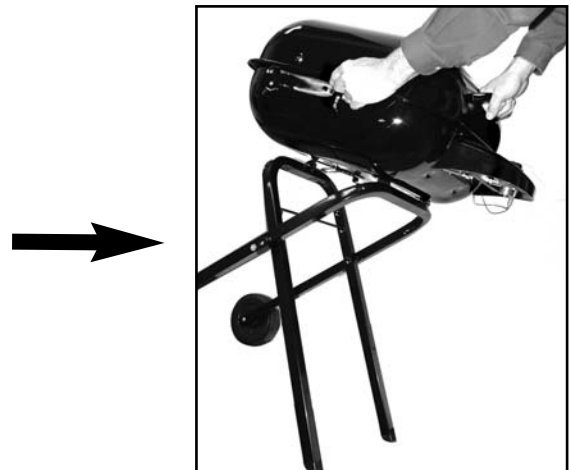
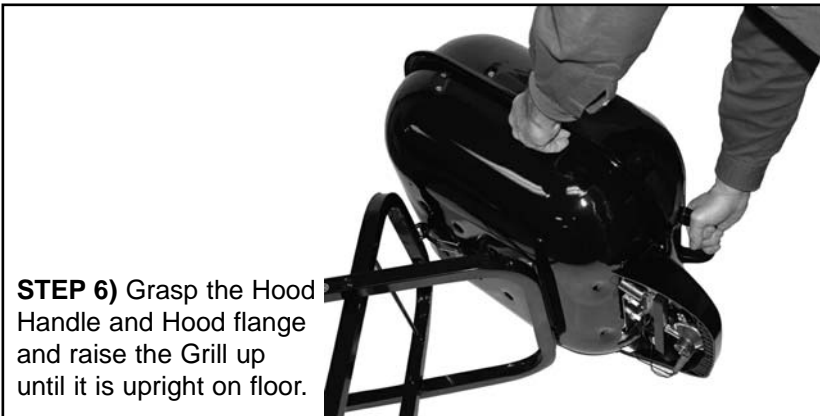
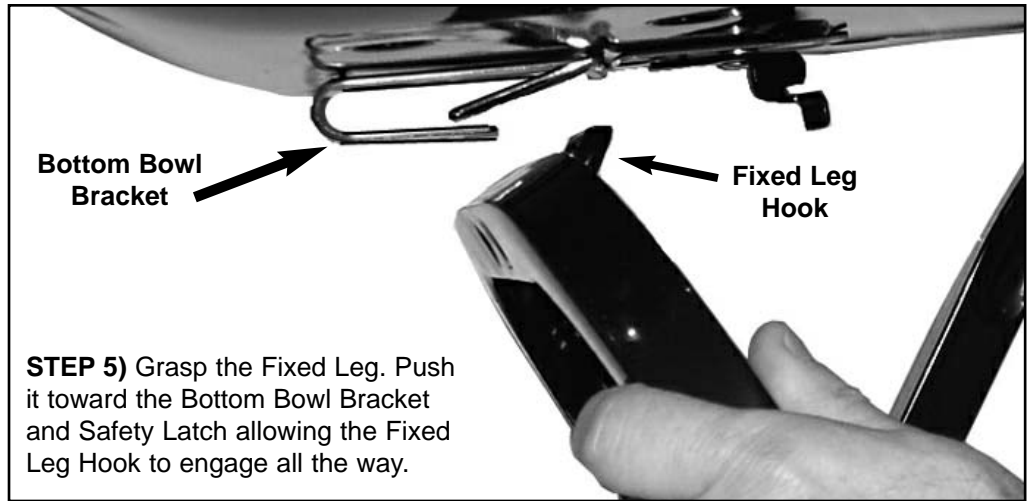
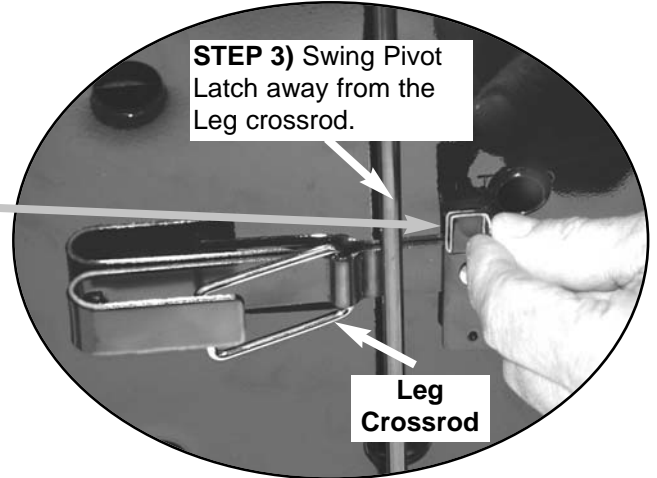
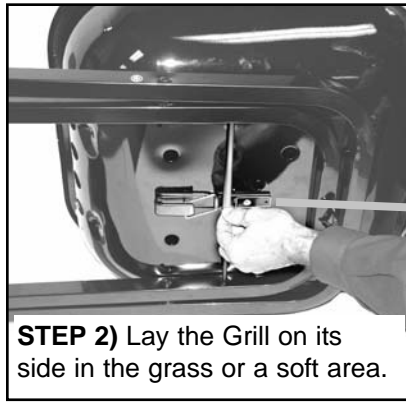
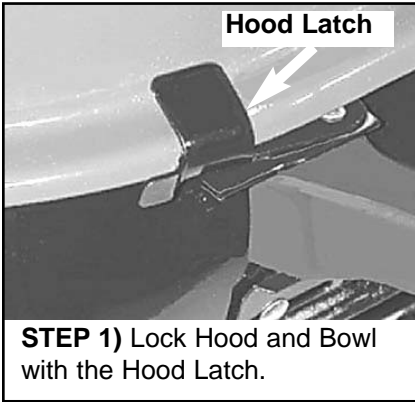

INSTALL GREASE CUP

WARNING

To reduce the risk of serious bodily injury or death:

- Failure to Empty the Grease Cup underneath the Bowl after each cooking session could result in a grease fire in the Cup or Bowl.
- Never light the LP gas grill without the Grease Cup installed.

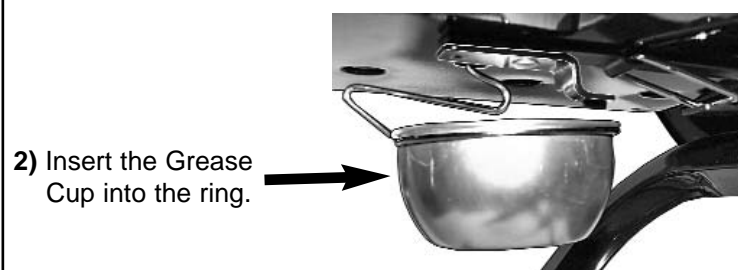
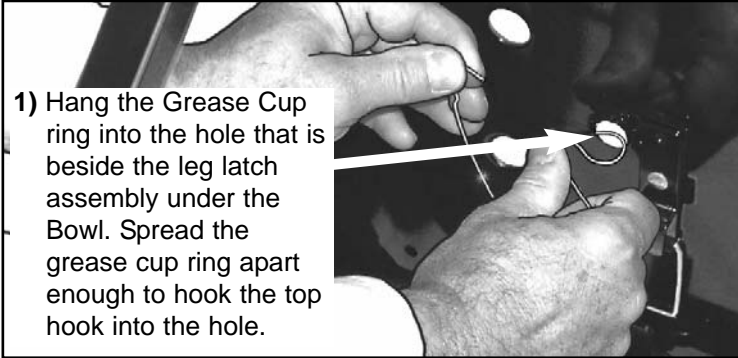

Connecting/Disconnecting LP Gas Cylinders

INSTALLATION CODES

WARNING

To reduce the risk of serious bodily injury or death:

- This installation must conform with local codes or, in the absence of local codes, with either the National Fuel Gas Code, ANSI Z223.1, or CAN/CGA-B149.2, Propane Installation Code.
- If an external electrical source is utilized, the outdoor cooking appliance, when installed, must be electrically grounded in accordance with local codes or, in the absence of local codes, with the National Electrical Codes, ANSI/NFPA 70, or the Canadian Electrical Code.

LP CYLINDER

WARNING

To reduce the risk of serious bodily injury or death:

- Read and follow all warnings on LP gas cylinder.
- If you see, smell, or hear the hiss of LP gas escaping from the cylinder:
 - 1) Evacuate all people from the grilling area.
 - 2) Do not attempt to correct the problem yourself.
 - 3) Call the local fire department.

- Do not operate the LP gas grill without the 1 lb. LP gas cylinder or a 20 lb. cylinder connected to the grill as shown in Assembly Instructions .
- Maintain cylinder in upright position to provide for proper fuel withdrawal.
- Do not use an LP gas cylinder if it shows signs of dents, gouges, bulges, fire damage, corrosion, leakage, excessive rust or other forms of visual external damage; it could be hazardous and should be checked by a liquid propane supplier
- Never connect or disconnect LP cylinder or fittings near open flame or while grill is burning.
- When the LP gas cylinder is connected, keep the grill outside in a well-ventilated space.
- Turn off control knob to grill when grill is not in use.
- Do not attempt to refill or repair a 1 pound disposable LP cylinder. It could cause a hazard or explosion.

NOTE: Your Gas Grill uses a 1 lb. Disposable LP Cylinder but a 20 lb. cylinder can be used with a 4 ft adapter hose purchased separately from a local retailer. Follow the manufacturer's instructions for the adapter hose use.

LP Cylinders, for use with Aussie® LP gas grills, must meet the following requirements:

- 1) Only use cylinders marked "Propane Fuel."
- 2) 1 pound Cylinder size should be 4" diameter x 8" tall.
- 3) 20 lb Refillable Cylinder size should be 12" Diameter x 18" tall. Overfill Protection Device (OPD) safety feature must be noted on the cylinder and must have a collar to protect the LP cylinder valve.
- 4) Cylinder must be constructed and marked in accordance with the U.S. Department of Transportation (DOT) or the National Standard of Canada, CAN/CSA-339. (See LP cylinder marking)
- 5) Cylinder must have a cylinder cap to protect LP cylinder valve when not in use.

REGULATOR/MANIFOLD ASSEMBLY

WARNING

To reduce the risk of serious bodily injury or death:

- Use only the Regulator/Manifold Assembly that has been supplied with this gas grill. Do not use a Regulator/Manifold from another manufacturer.
- Always check for gas leaks when you connect and disconnect the LP gas cylinder.
- Inspect Regulator/Manifold Assembly before each use. Replace Regulator/Manifold Assembly before using grill if there is evidence of dents, bends, or damage.
- Inspect Adapter Hose before each use. If there is evidence of excessive abrasion, wear or there are cuts, replace hose before using grill. Make sure there are no sharp bends in the hose.
- Make sure Adapter Hose does not contact hot metal surfaces.
- If the Regulator/Manifold Assembly is not working properly and you need a replacement, contact the manufacturer (1-800-251-7558). Be sure to specify your grill model.

ATTACH LP CYLINDER TO GAS GRILL

1 LB. LP CYLINDER

1) Make sure the Control Knob is in the "LOCK/OFF" position.



2) Remove the Cylinder Protective Cap from the LP cylinder gas nozzle.



3) Hold 1 lb. LP cylinder upright. Push the LP cylinder nozzle into regulator nipple and turn clockwise. Keep the LP cylinder straight while turning it. Make sure the connection does not cross thread. Hand tighten only until a snug fit is obtained. Do not use tools.



4) Perform a Leak Test.. (See next page)

20 LB. LP CYLINDER

⚠ WARNING

To reduce the risk of serious bodily injury or death:

- Always place 20 lb. cylinder away from gas grill and traffic areas to prevent tripping over the hose.
- Always turn off grill and disconnect the gas cylinder before moving the gas grill.

1) Make sure the Control Knob is in the "LOCK/OFF" position.



2) Remove the Cylinder Protective Cap from the LP cylinder gas nozzle.

3) Push the hose end into the regulator nipple and turn the knurled knob clockwise. Keep the threaded knob straight while turning it. Make sure the connection does not cross thread. Hand tighten only until a snug fit is obtained. Do not use tools.

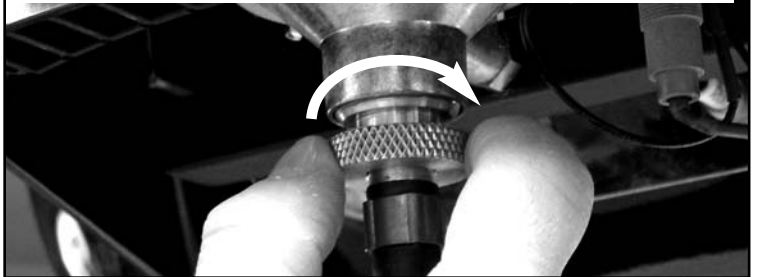

5) Align the Coupling nut at other end of hose and engage it with the LP cylinder nozzle. Turn the coupling nut clockwise and hand tighten.

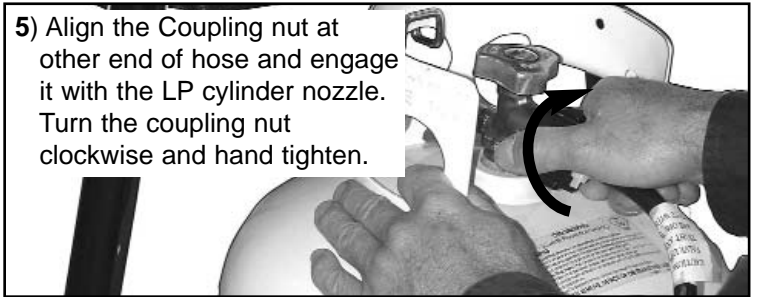

6) If using a 20 lb. LP Cylinder, place it about 3 ft. directly to the left or right side of the legs out of traffic areas. Be sure to leave some slack in the hose.

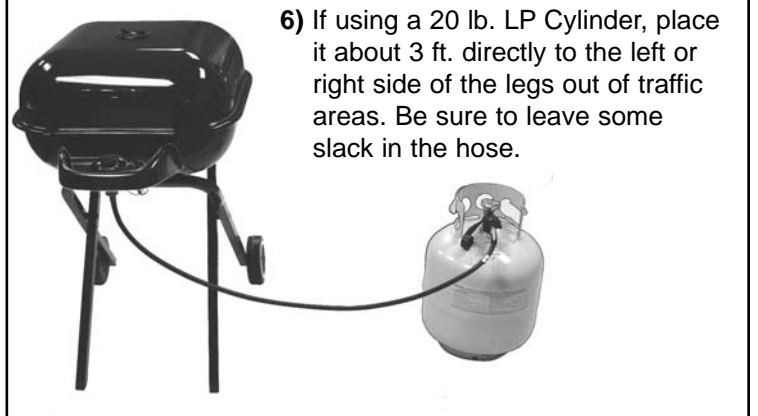

7) Perform a Leak Test. (See next page)

OPERATING AND MAINTAINING YOUR GAS GRILL

BEFORE USING YOUR LP GAS GRILL

USING GAS

⚠ DANGER

CARBON MONOXIDE HAZARD

- This appliance can produce carbon monoxide which has no odor. Using it in an enclosed space can kill you.
- Never use this appliance indoors, on recreational vehicles, or boats.

⚠ WARNING

To reduce the risk of serious bodily injury or death:

- LP gas is not natural gas. Do not attempt to convert an LP unit to natural gas or a natural gas unit to LP gas. Any unspecified use or alteration of this unit could be unsafe and will void your warranty.
- Always use a gas appliance outdoors in an open area with good ventilation to avoid breathing toxic fumes from leaking gas, explosion or fire. In addition, the combustion products of such fuels, including liquefied petroleum (LP), contain chemicals known to the state of California and other authorities to cause cancer, birth defects and other reproductive harm.

SELECTING A LOCATION

⚠ WARNING

To reduce the risk of serious bodily injury or death:

- Keep grill and accessory appliances clear and free from combustible materials, gasoline and other flammable vapors and liquids.
- Locate your LP gas grill in an open area with good ventilation and at least 10 feet away from your house or building. Do not use the grill in a garage, breezeway, carport, porch, high traffic area or under any surface that can catch fire.
- Minimum clearance from sides and back of grill to adjacent combustible construction below top of unit should be 36 inches from sides and 36 inches from back. Minimum horizontal clearance from sides and back of grill to adjacent vertical combustible construction extending above top of unit should be 36 inches from sides and 36 inches from back.
- Locate your LP gas grill on a level stable surface in an area clear of combustible material.
- Do not use an LP gas grill indoors, on recreational vehicles, or boats.
- Do not use gas grill as a space heater.
- Make sure legs are locked fully open before using grill.

PERFORMING A LEAK TEST

⚠ WARNING

To reduce the risk of serious bodily injury or death:

- Always perform a leak test before each use.
- Never use a match or open flame to test for gas leaks.
- Perform a leak test in a well ventilated area.
- Do not perform a leak test on a grill while it is hot or in use.
- Do not use the LP gas grill if you detect a gas leak that cannot be corrected by using the leak test procedures.

Before using your gas grill perform a leak test on the LP Cylinder connections and hose connections.

Supplies Needed for a Leak Test: Clean paint brush, water, and dish washing liquid.

- 1) Set up your grill at the location where you will be using it. Open Hood Vent, then fully open the Grill Hood.
- 2) Mix one part of water with one part of dish washing liquid.

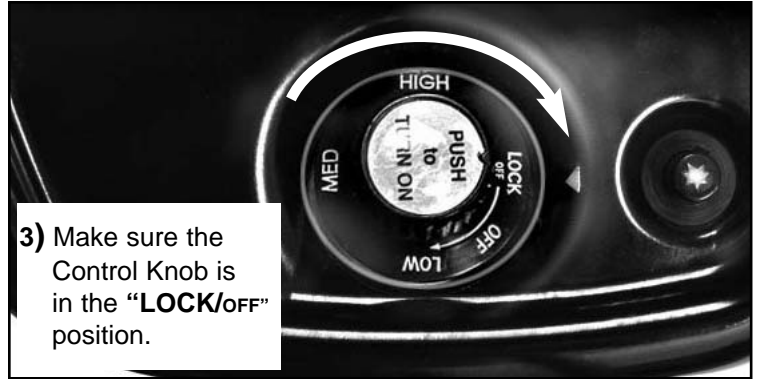

- 3) Make sure the Control Knob is in the "LOCK/OFF" position.

- 4a) Attach 1 lb. LP cylinder to the regulator (See previous page).
- 4b) Brush soap solution generously around LP Cylinder Connection. If "growing" bubbles appear, then you have detected a gas leak.

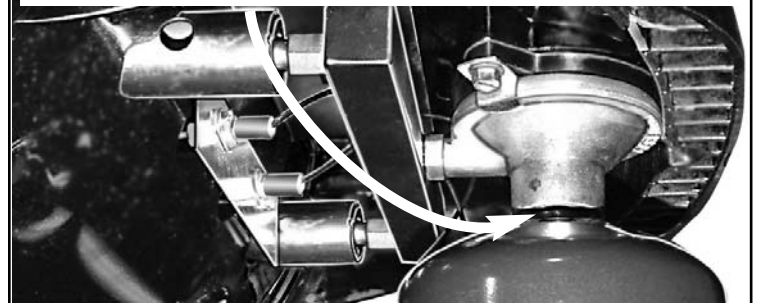

- 4c) If a leak appears at the 1 lb. cylinder/regulator connection, unscrew the cylinder and retighten but do not overtighten. (Note: Only hand tighten. Do not use any tools.) Repeat Leak Test. If a leak cannot be stopped, disconnect the LP cylinder and do not use the grill. Call Customer Service at 1-800-251-7558.

- 5a) If using a 20 lb. cylinder, turn cylinder handle counterclockwise to "On".

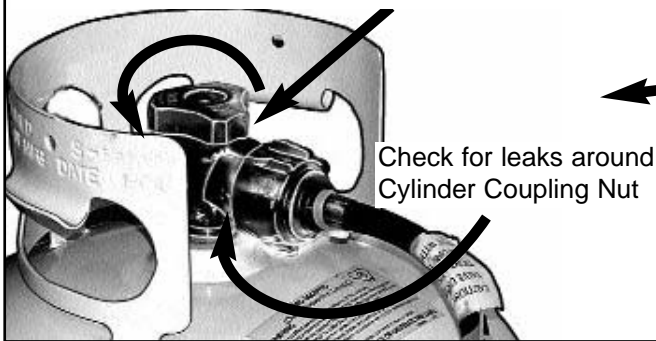

- 5b) Check for leaks around Adapter Hose to Regulator Connection.



- 5c) If a leak appears at the 20 lb. cylinder/adapter hose connection or adapter hose/regulator connection, unscrew the hose and retighten, but do not overtighten. (Note: Only hand tighten. Do not use any tools) Repeat Leak Test. If a leak cannot be stopped, disconnect the LP cylinder and Do not use the grill. Call Customer Service at 1-800-251-7558.

- 6) Upon completion of leak test:

- Disconnect LP cylinders from the regulator control.
- Turn 20 lb. cylinder valve clockwise to the "Off" position.

- 7) Place the protective cap over the LP cylinder gas nozzle. Store the cylinder in a safe place.

If no leaks are found, the grill is ready to use.

LIGHTING THE GAS GRILL

IGNITION LIGHTING THE GRILL

⚠ WARNING

To reduce the risk of serious bodily injury or death:

- Open Hood and all vents before lighting the grill to prevent an explosion from gas build-up.
- Make sure there are no obstructions to the flow of combustion and ventilation air to the grill burners.
- During failed lighting attempts, or a burner goes out during the cooking process; turn control knob "Off" to dissipate any accumulation of gas. Wait five minutes before repeating lighting procedure.

- 1) Attach LP cylinder. Open the top Hood vent, then open the Hood all the way.
- 2) **Important:** Make sure grill control knob is turned "Off" first.
- 3) If using a 20 lb. LP Cylinder, turn handle counterclockwise to "ON".

- 4) Push in Control Knob and turn counter clockwise to the "High" position.

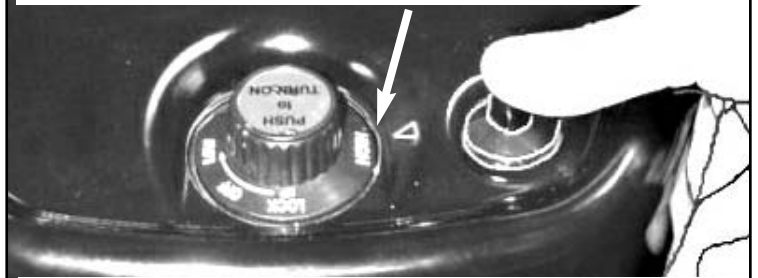

- 5) Push Ignitor button in several times to light the burner. Listen for the spark ignition and look to make sure all burner holes are lit. If no spark, see [Troubleshooting Section](#) and [figure below](#).

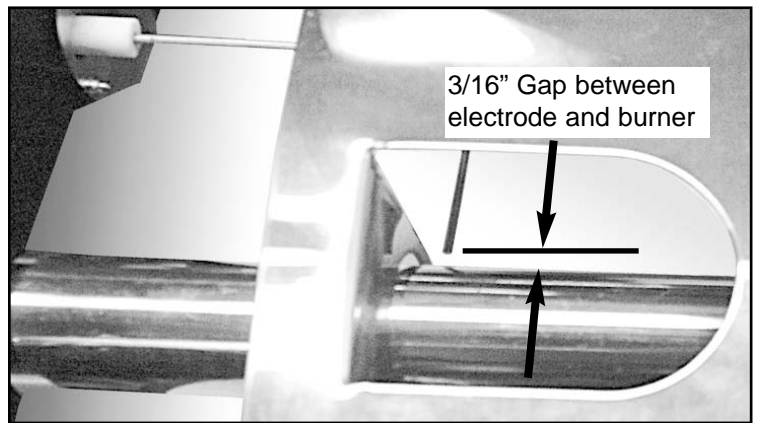

- 6) If Grill burner fails to light, repeat Steps 2-4.

If the burner fails to light after three or four attempts following Steps 2-5, turn control knob to the "Off" position. Wait five minutes; then repeat the lighting procedure. NOTE: If the burner still fails to light, refer to the [Troubleshooting Section](#). The burner can also be lit manually, see [Manual Lighting The Grill](#).

- 7) After ignition, install the Cooking Grid. Turn the control knob to "High" for 3-8 minutes and close the Hood to preheat the Cooking Grid and the grill. Preheat the grill before every cooking session.)

If the burner goes out during operation, turn the control knob to the "Off" position. Open hood and wait five minutes before attempting to relight the grill. If it does not relight, turn control knob to the "Off" position. Make sure there are no open flames nearby, then disconnect the cylinder and see if it is empty.

MANUAL LIGHTING THE GRILL

⚠ WARNING

To reduce the risk of a serious burn injury when lighting the grill manually:

- Always light the burner with a long match holder.
- Keeps hands and fingers away from the burners.

- 1) Attach LP cylinder. Open the top Hood vent, then open the Hood all the way.
- 2) **Important:** Make sure grill control knob is turned "Off".
- 3) If using a 20 lb. LP Cylinder, turn handle counterclockwise to "ON". (See p. 8)

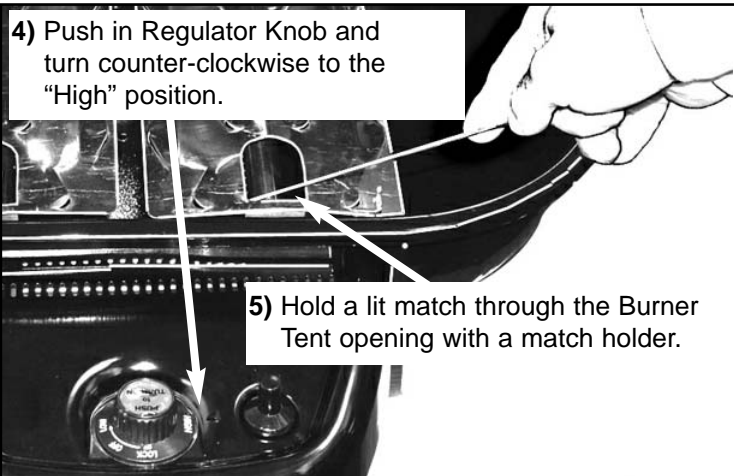

- 6) If Grill burner fails to light, repeat Steps 3-4.

If the burner fails to light after three or four attempts following Steps 3-5, turn control knob to the "Off" position. Wait five minutes; then repeat the lighting procedure. NOTE: If the burner still fails to light, refer to the [Troubleshooting Section](#).

If the burner goes out during operation, turn the Control knob to the "Off" position. Open hood and wait five minutes before attempting to relight the grill. If it does not relight, turn control knob to the "Off" position. Make sure there are no open flames nearby, then disconnect the cylinder and see if it is empty.

CHECK YOUR FLAME

Your burners have been preset by the manufacturer for optimal flame performance. A blue flame, possibly with a small yellow tip, is the result of the optimal air and LP gas mixture.

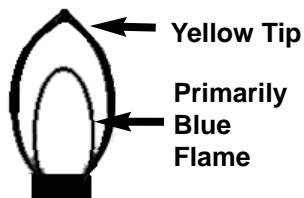

Check the flame before each cooking session and throughout the grilling season. Always check especially after long periods of storing the grill. If the flame is significantly yellow in color, the appropriate amount of LP gas in the air/LP gas mixture is not correct. This could be due to a blocked burner from grease drippings or from insects building a nest inside the burner or burner opening. See [How to Clean the Burners](#).

OPERATING THE LP GAS GRILL

⚠ WARNING

To reduce the risk of serious bodily injury or death:

- Never use charcoal in your LP gas grill. Do not use aerosols or store flammable liquids or materials near this gas grill.
- Check the LP gas grill for gas leaks and Burner obstructions before each use.
- To prevent an explosion from gas build-up, always open the hood before lighting the LP gas grill.
- Do not attempt to extinguish a grease fire with water or other liquids. Have a BC fire extinguisher nearby.
- Do not douse or spray the grill or cooking grid with water when hot. Burns from the splattered grease or water could occur.
- If your LP gas grill catches on fire:
 - If the fire is inside the grill and you can safely reach the control knob, then turn it to the off position.
 - If the fire involves the cylinder, leave it alone, evacuate the area and call the fire department.
 - If there is any type of fire that threatens either personal safety or endangers property, call the fire department.
- Do not use grill without Grease Cup installed. Empty excess grease to avoid a grease fire under the bowl.
- If you notice grease or other hot material dripping from the grill onto the Regulator Control, turn off the control knob immediately. After the grill has cooled, determine the cause and correct it. After cleaning the regulator assembly, perform a leak test before continuing use. (See [Performing a Leak Test](#).)
- Do not operate an LP gas grill if you have knowledge of or suspect a gas leak.
- Do not wear loose clothing (example: hanging shirt tails, clothing with frills, etc.) around a LP gas grill while in use or hot.
- Do not lean your body over the LP gas grill when lighting it or while it is in use or hot.
- Do not touch hot surfaces. Use heat resistant gloves, long-handled tongs, or cooking mitts at all times since the grill will become very hot. Open the hood carefully when cooking to avoid the hot air and steam trapped inside.
- Do not allow children to operate or play near an LP gas grill. Keep animals and bystanders out of the grill area. Do not leave grill unattended.
- Do not move an LP gas grill when in use or hot.
- Do not allow cords of any electric appliance or rotisserie near heated surfaces of the LP gas grill; place electric cords away from walkways to avoid a tripping hazard.
- Always disconnect LP gas cylinder when not in use.
- Allow grill to cool before handling parts or cleaning.
- Remove grill covers and store at least 36 inches from the LP gas grill while in use. Grill covers are made of a flammable material. Allow the grill to completely cool before putting a cover back on the grill.

COOKING ON YOUR GRILL

WARNING

To reduce the risk of burns, overheating or a serious hazard:

- Do not close the the Hood or vent while preheating.
- Do not preheat more than the 8 minutes on the “High” position.
- Use barbecue mitts when handling the Cooking Grid when it is hot.
- Do not move an LP gas grill when in use or hot.
- Use long handle heat resistant or wooden utensils for removing food from Cooking Grid.
- Always make sure the Grease Cup is empty and is properly installed under the Bowl before each cooking.
- Do not leave any utensils on a hot Cooking Grid.
- Do not set hot grid on surfaces that will melt or scorch.

- 1) Make sure the Cooking Grid is clean. (See Cleaning the Grill.)
- 2) Open the top Hood vent, then open the Hood all the way.
- 3) Place the Cooking Grid in the bowl and light the grill.
- 4) Turn the control knob to “High” for 3-8 minutes and preheat the grill. Preheat the grill before every cooking session.) During the first use, there may be a slight odor from the curing oil on paint or parts.
- 5) After preheating, carefully place food on the Cooking Grid. Cook until done, turning food at least once halfway through the cooking time for most foods. Adjust flame as needed with the Control Knob.

For SLOWER cooking, shift the Cooking Grid toward the rear and into the upper Grid Bracket slots. For FASTER cooking, shift the Cooking Grid toward the front and into the lower Grid Bracket slots. Use the lower position for searing steaks and hamburgers or when more heat is needed. Foods cook very fast at this position, so watch your food carefully.

Raise the grid to the upper slot to finish cooking steaks and hamburgers. Start cooking with the grid in the upper position for meats, such as pork and chicken, that have to be cooked a long time. The top grid height is good for any time your fire is very hot.

- 6) When you have finished cooking,, turn the control knob “OFF”. Remove food from Cooking Grid with long-handled heat resistant or wooden utensils, or you can remove the Cooking Grid with your food still on the Cooking Grid. **(Be sure to use barbecues mitts while handling the Cooking Grid.)** Place the Cooking Grid on a table or countertop. The foot rests will not allow your food to touch the table top or counter surface. Do not set the hot grid on surfaces that will melt or scorch.

END OF COOKING SESSION

WARNING

To reduce the risk of serious bodily injury or death:

- Always turn “OFF” the Regulator Knob and remove the LP Cylinder when not in use. Damage or severe impact may loosen the assembly and cause gas to leak outside the burner area.
- To avoid burns, allow the grill and the grease in the Grease cup to cool before emptying, handling parts or cleaning.
- To reduce the risk of a fire, empty the Grease cup after each cooking session so excessive grease does not accumulate.
- Never light the LP gas grill without Grease Cup in place.

- 1) When you have finished using your grill, turn the grill Control Knob clockwise to the “Off” position. Make sure there are no open flames nearby.
- 2) Disconnect the LP cylinder from the Regulator Control.
- 3) Wait until the grill is cool before closing the hood, the top Hood Vent cleaning or putting on a cover.
- 4) Regularly clean your LP gas grill between uses and after extended storage periods.

CARE AND MAINTENANCE

CLEANING THE GRILL

CAUTION

To reduce the risk of a cut injury:

- Be careful or wear protective gloves when cleaning grill parts that could have sharp edges.

CAUTION

- Do not clean any grill part in a self-cleaning oven. The extreme heat will damage the finish.
- Never use oven cleaner, steel wool or other abrasive cleaning product on the painted surfaces. These will cause damage to the finish or parts.

Regularly clean your LP gas grill between uses and after extended storage.

- 1) **Grease Cup**-Remove Grease Cup and wash with a mixture of hot water and dish detergent.
- 2) **Cooking Grid**-Remove and clean the Cooking Grid with a wire brush, paper towel or sponge. After completely cooled, the Cooking Grid can be washed with warm, soapy water or scrubbing pad.
- 3) **Hood**-It is not necessary to remove all the grease from inside the hood. Wipe the outside hood and body with paper towels or soft damp cloth. For further cleaning, use warm soapy water and a cloth. Do not use steel wool, oven cleaner or other abrasive cleaners that can scratch the painted surfaces.
- 4) **Bowl**-Remove excess grease and/or fat from the Bowl with a soft plastic or wooden scraper or nylon-bristled brush only. Rinse and dry thoroughly. Do not immerse the gas control. Avoid getting water in the Burner Holes.
- 5) **Burners**-(See next page)

CLEANING THE BURNERS

⚠ WARNING

To reduce the risk of fire beneath the grill:

- Inspect and clean clogged burner/venturi tubes for insects and insect nests.
- Make sure LP cylinders are disconnected from the grill Burner, the control knob is turned off, and the grill is completely cooled before cleaning the burners.

Provided that the Burner is operating correctly, in normal usage, burning off the residue after cooking will keep the Burner clean. The Burner should be removed and cleaned annually, or whenever heavy build-up is found, to ensure that there are no signs of blockage (debris, insects) in either the burner ports, the primary air inlet, or the neck of the burner.

Clean the Burners annually, or whenever heavy build-up is found, to ensure that there are no signs of blockage (debris, insects) in either the burner portholes, the primary air inlet, or the neck of the burner.

How to Clean the Burners:

1) Open the hood and remove the Cooking Grid.

2) Close the hood. Remove burner screw from rear of Bowl from the back side of Bowl.

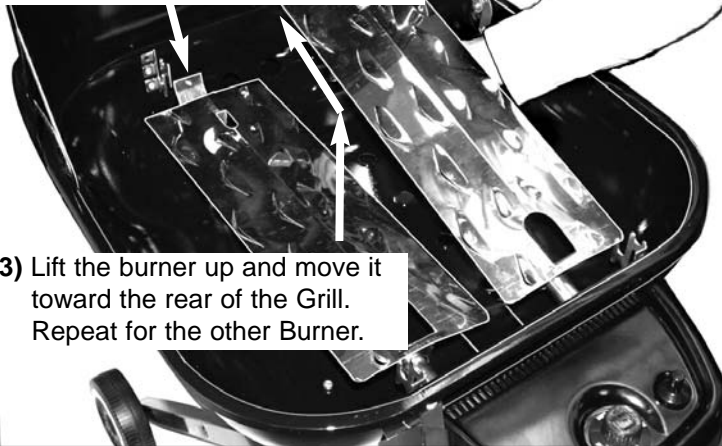

3) Lift the burner up and move it toward the rear of the Grill. Repeat for the other Burner.

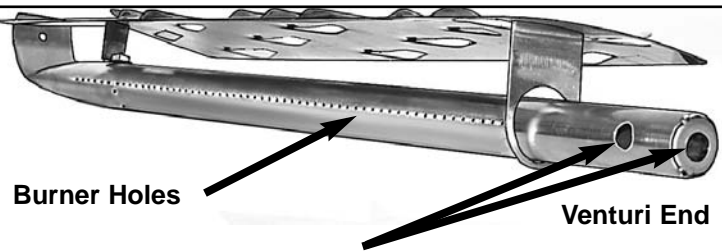

4) Use a pipe cleaner to clear obstructions or insect nests from the air inlet holes and Venturi end. Use a brass wire brush to remove surface rust or corrosion. Open up clogged burner holes with a small nail or wire. **Do not immerse the Burner in water.** Remove any water that gets in the Burner.

Note: Before Reassembly of Burners you may want to fully clean the grill. See [Cleaning the Grill](#) previous page. If grill is to be stored, coat Burners lightly with cooking oil and wrap in a protective cover to keep insects out.

5) Re-install the Burners. Note: Make sure the Manifold nozzles protrude inside the Burner Venturi tubes. Re-tighten the rear Burner screws.

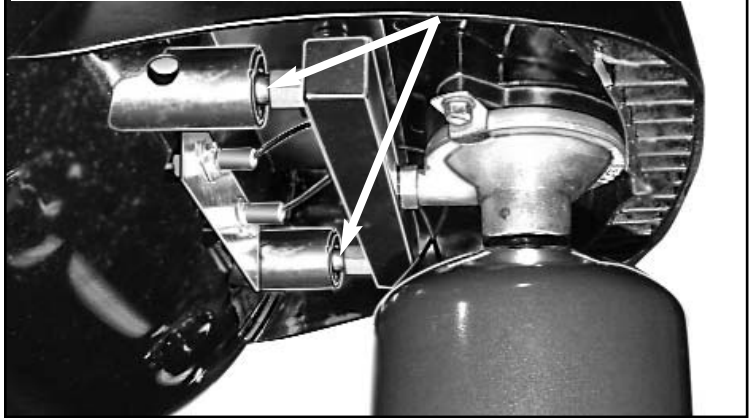

6) Check burner operation after re-assembly.

7) Re-install Cooking Grid and Grease Cup.

STORAGE AND TRANSPORT

⚠ WARNING

To reduce the risk of serious bodily injury or death:

- Always turn "OFF" the Regulator Knob and remove the LP Cylinder when not in use. Damage or severe impact may loosen the assembly and cause gas to leak outside the burner area.
- Always allow grill to cool and Lock the Grill Hood with the Hood/Bowl latch before transporting.
- Store your LP gas grill in a cool, dry place. You can store your grill indoors only if the cylinders are disconnected.
- Do not store an LP cylinder indoors (empty or filled). Make sure there are no open flames nearby, then disconnect the LP cylinders from the gas grill. Re-cap LP Cylinder with the Safety Cap. Store LP cylinders outdoors out of the reach of children.
- To avoid an explosion, do not leave an LP cylinder inside a vehicle that can become overheated by the sun. Do not store an LP cylinder in any space greater than 125 degrees Fahrenheit.
- Even though an LP cylinder may appear to be empty, gas may still be present and the cylinder should be transported and stored safely.
- Do not store a spare LP gas cylinder under or near the LP gas grill.
- Check your LP gas grill for gas leaks, deterioration, proper assembly, and burner obstructions before using the grill after periods of storage and/or non-use (i.e. over winter).

- 1) Wrap aluminum foil around the Burners to prevent insects from entering the burner holes. Before next use, remove aluminum foil from Burners.
- 2) To maintain the condition and extend the life of your grill, cover the unit when stored outside for any length of time, especially during the winter months.
- 3) Periodically check and tighten all nuts, bolts, and screws. Make sure all electrode and ground wires are not loose.
- 4) Make sure the Grill works mechanically and that the Grill Hood locks.

CAUTION

To reduce the risk of injury or parts falling out during transport:

- Make sure legs are folded and locked and Hood and Bowl is latched securely.

To transport or store your grill....

- 1) Remove the grease cup. Disconnect the LP Cylinder and properly store it away.
- 2) Lock the Hood and Bowl with the latch. Make sure it is securely latched.
- 3) Lay the Grill on its side. Fold the legs under the grill in the reverse order of page 4 instructions. Lock the legs with the leg pivot latch.
- 4) Lift the Grill up to allow wheels to roll.
- 5) Transport your grill by holding the Hood handle. **(FIG. A)** To store away, lean your grill against a wall resting on the fixed leg plugs **(FIG. B)** or hang on the side of a wall **(FIG. C)**. Hang grill under the folded legs. **Do not hang grill by the Control Panel.**



IMPORTANT NOTICE

(Only if using a 20 lb. LP Cylinder and an adapter hose)

The Gas Grill is can be setup to operate with a LP Gas Cylinder equipped with an OPD (Overfilling Prevention Device).

This is a secondary device to prevent the overfilling of your LP Gas cylinder. The proper methods for the filling of your LP Gas cylinder are by weight or volume, as described in NFPA 58. Please make sure your filling station fills your LP Gas cylinder by weight or volume. Ask your filling station to read purging and filling instructions on the LP cylinder before attempting to fill.

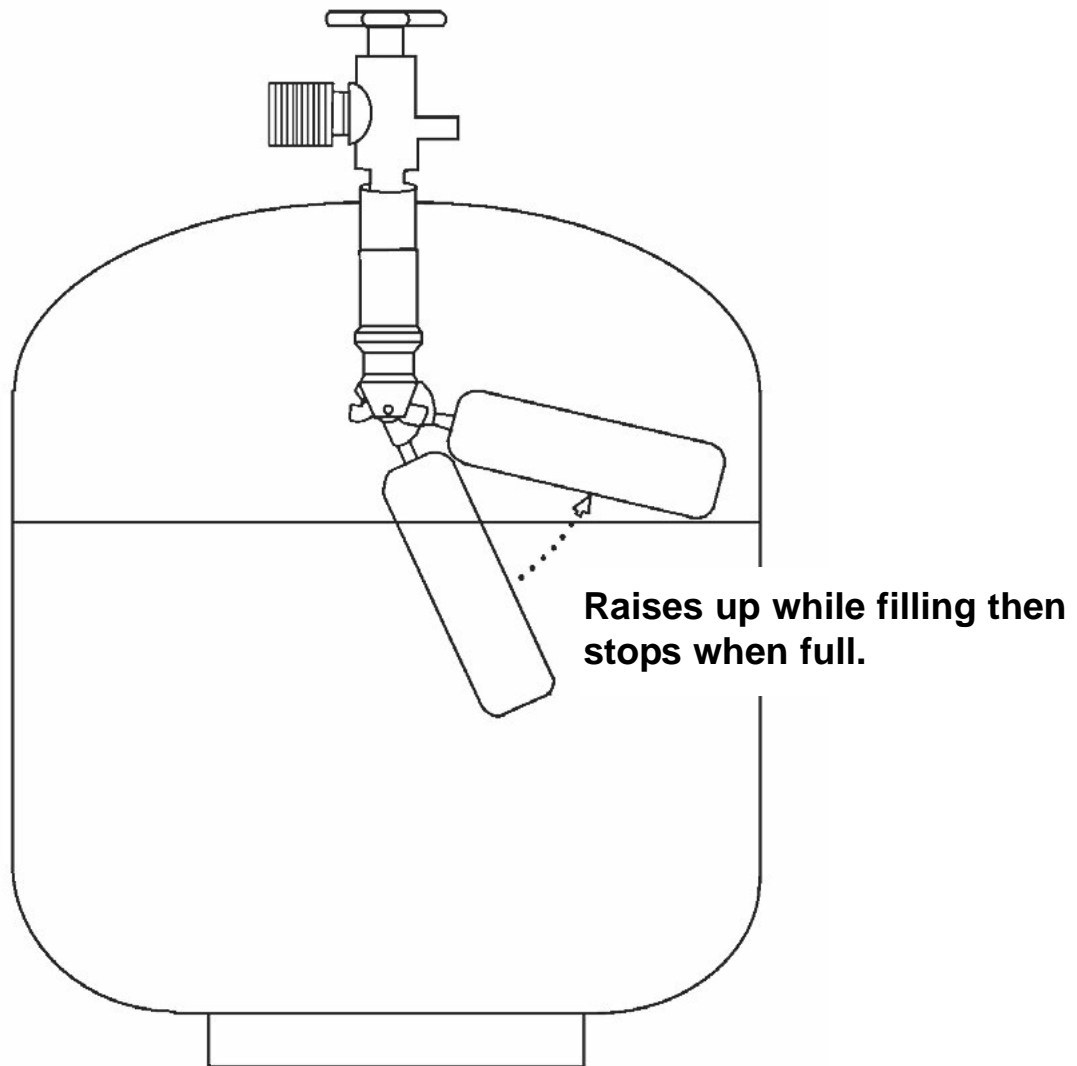

WARNING

Do not exchange the LP Gas cylinder unless the exchange LP Cylinder is equipped with an OPD. Otherwise you will lose the OPD (Overfilling Prevention Device) feature. If there is not an LP cylinder available for exchange equipped with an OPD, we recommend that you have your cylinder filled at an authorized LP gas dealer by a qualified attendant.

TROUBLESHOOTING

Problem:	Possible Cause:	Solution:
Burner will not light with the Ignitor or match	Not pausing long enough before clicking the Ignitor Button	When lighting the Burner, push-in and turn Regulator knob counter-clockwise to the high position. Push in Ignitor button several times so that it clicks each time.
	No spark	The spacing between electrode and Burner ports should be approximately 3/16". Make sure wire connections are secure and burner is attached securely to brackets.
	LP gas cylinder is empty	Dispose of empty cylinder and replace with a full one.
	LP Cylinder not fully connected	Tighten 1 lb. Cylinder by hand or adaptor hose connections to 20 lb. cylinder. Do not use tools.
	Obstructions in Burner or Burner not connected to Valve.	Make sure burner tube is over the gas nozzle. See How to Clean the Burners #5 page 11: Re-install after cleaning.
	Electrode and burner are wet	Dry electrode with clean cloth, air dry or use a blow dryer.
	Wire is loose or disconnected	Reconnect the wire.
	Wire is shorting (sparking between ignitor wire and electrode)	Replace Ignitor wire/electrode assembly (Call the Customer Service Department @ 1-800-251-7558)
	LP Excess flow valve tripped in regulator	Turn control knob to "Off" position. Wait five minutes. Relight LP gas grill. If flame remains to be low, turn off gas at the grill. Disconnect the regulator from the LP gas cylinder. Reconnect the regulator to the LP gas cylinder. Perform a leak test; relight grill. This will reset the excess flow valve.
Low flame or low heat	Obstructions in Burner or Burner not connected to Valve.	Make sure burner tube is over the gas nozzle. See How to Clean the Burners #5 page 11: Re-install after cleaning.
	LP gas cylinder is low	Replace empty 1 lb. cylinder or refill 20 lb. cylinder.
	LP Excess flow valve tripped in regulator	Turn control knob to "Off" position. Wait five minutes. Relight LP gas grill. If flame remains low, turn off Control knob at the grill. Disconnect the LP Cylinder, then re connect it. Perform a leak test; then relight grill. This will reset the excess flow valve.
Flames blow out	High or gusting winds	Turn grill in a different direction or increase flame height.
	LP gas cylinder is low	Replace empty 1 lb. cylinder or refill 20 lb. cylinder.
	Excess flow valve tripped	See "Low flame" problem above.
Flare up	Grease build up	Clean the grill.
	Excessive fat in meat	Trim fat from meat before grilling.
Persistent grease fire	Grease trapped around burner system	Turn control knob "Off". Open hood carefully and let fire burn out. After the grill cools, remove and clean all parts. Clean Grease Cup.
Humming or whistling from the regulator	Outside temperature, humidity, barometric pressure, and the gas level within cylinder may cause rubber diaphragm inside the regulator to vibrate, with a humming or whistling sound.	Although this sound may be alarming, this is NOT dangerous as long as it is not accompanied by the smell of gas. Simply adjust the burner settings and usually the sound will subside. If the humming sound persists, a change in atmospheric conditions will eventually stop the vibration. Should you smell gas, do not use the grill and call Customer Service at 1-800-251-7558

If your problem is not resolved from the information above, please call Customer Service at 1-800-251-7558.

WARRANTY

MECO CORPORATION LIMITED WARRANTY

This product is warranted to the original consumer purchaser against defects in material and workmanship under normal outdoor household use and correct assembly (if assembled by the consumer-purchaser). All parts are warranted for a period of (90) days from the date of purchase. Mecco Corporation DOES NOT warrant in any way the propane cylinder (see label on cylinder for cylinder manufacturer's warranty.) The LP cylinder manufacturer is responsible for the materials, workmanship and performance of the cylinder. If the cylinder has a defect, malfunctions, or you have a question regarding the cylinder, call the cylinder manufacturer's customer service center. The phone number is on the cylinder. If the cylinder manufacturer has not resolved the issue to your satisfaction, then call Mecco Corporation at the customer service number listed below.

Mecco Corporation will require reasonable proof of purchase and we require you keep your original receipt. Damages caused by commercial or institutional use, accidental or intentional damage, repairs made or attempted by unauthorized persons, or misuse are not covered by this warranty. If defective, the part or product will be repaired or replaced at the option of Mecco Corporation without charge.

This warranty does not include the cost of any inconvenience or property damage due to failure of the product and does not cover damage due to misuse, abuse, accident, damage arising out of transportation of the product, damage incurred through commercial use, or failure to perform normal and routine maintenance. LIABILITY FOR CONSEQUENTIAL PROPERTY OR COMMERCIAL DAMAGES ARE EXPRESSLY EXCLUDED BY THIS WARRANTY. ANY APPLICABLE IMPLIED WARRANTIES OF MERCHANTABILITY AND FITNESS ARE LIMITED IN DURATION TO THE PERIOD COVERAGE OF THIS EXPRESS WRITTEN LIMITED WARRANTY. Some states do not allow limitation on how long an implied warranty lasts, so this limitation may not apply to you.

Deterioration or damage due to severe weather conditions such as hail, hurricanes, earthquakes or tornados, discoloration due to exposure to chemicals either directly or in the atmosphere, is not covered by this limited warranty.

No returns will be accepted without prior authorization from Mecco Corporation. Authorization for return may be obtained by calling 1-800-251-7558. Handling and transportation costs for returning the product are not covered by this warranty and will be paid for by the purchaser. Please send your correspondence to:

Mecco Corporation
1500 Industrial Road
Greeneville, TN 37745

For reference and correspondence,
record your Serial number here.
(See nameplate on side of grill.)

Serial No.
Please use this number in registering
your warranty and any correspondence
with Mecco Corporation.

Aussie[®] by Meco[®]